

Precision in Every Dimension

Products Catalogue 2020

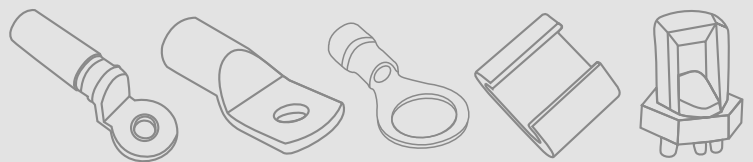



Precision in Every Dimension

Tubular Cable Lugs

Standard Type, With Inspection Hole
for Copper Conductors
Material: E-copper
Surface: Tin Plated

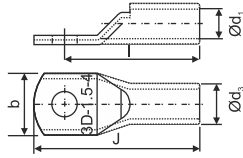

Con-Bolt mm ² -Φ	3D Cat.No.	d1	d3	b	J	Std Pkg	Price/ each ₹
1.5-4	3D-2622	1.8	3.7	8	16	3000	2.45
1.5-5	3D-2623	1.8	3.7	8	16	3000	2.33
1.5-6	3D-2624	1.8	3.7	10	18	3000	2.52
2.5-4	3D-2625	2.4	4.0	8	18	3000	2.70
2.5-5	3D-2627	2.4	4.0	8	18	3000	2.59
2.5-6	3D-2628	2.4	4.0	10	20	3000	2.75
2.5-8	3D-2629	2.4	4.0	11	24	2000	3.06
4-5	3D-2630	3.1	4.8	10	20	2000	3.72
4-5	3D-2632	3.1	4.8	9	20	2000	3.70
4-6	3D-2631	3.1	4.8	10	20	2000	3.67
4-8	3D-2633	3.1	4.8	12	24	2000	4.13
6-5	3D-2634	3.8	5.5	10	23	2000	5.36
6-6	3D-2635	3.8	5.5	10	23	2000	5.15
6-8	3D-2637	3.8	5.5	12	27	1600	5.83
6-10	3D-2638	3.8	6.2	16	32	1000	6.64
10-5	3D-2642	4.5	6.2	12	25	1600	6.55
10-6	3D-2643	4.5	6.2	12	25	1600	6.34
10-8	3D-2645	4.5	6.2	12	27	1200	6.54
16-5	3D-2652	5.4	7.1	12	30	1000	9.08
16-6	3D-2653	5.4	7.1	12	30	1000	8.84
16-8	3D-2655	5.4	7.1	12	32	1000	8.90
25-6	3D-2663	6.8	8.8	13	30	600	12.63
25-8	3D-2665	6.8	8.8	13	32	600	12.92
25-8	3D-2666	6.8	8.8	16	37	600	15.18
25-10	3D-2668	6.8	8.8	16	37	600	14.43
25-12	3D-2670	6.8	8.8	18	41	400	15.26
35-6	3D-2673	8.2	10.6	15	35	400	20.97
35-6	3D-2674	8.2	10.6	15	38	400	22.78
35-8	3D-2676	8.2	10.6	15	35	400	20.25
35-8	3D-2677	8.2	10.6	15	38	400	22.06
35-10	3D-2679	8.2	10.6	15	40	400	22.11
35-10	3D-2680	8.2	10.6	18	38	400	21.23
35-10	3D-2681	8.2	10.6	18	41	400	23.05
35-12	3D-2683	8.2	10.6	20	45	300	24.32
50-6	3D-2687	10.0	12.8	18	43	250	35.91

Con-Bolt mm ² -Φ	3D Cat.No.	d1	d3	b	J	Std Pkg	Price/ each ₹
50-8	3D-2689	10.0	12.8	18	43	250	34.91
50-10	3D-2691	10.0	12.8	18	43	250	33.60
50-12	3D-2695	10.0	12.8	18	47	250	35.09
70-6	3D-2697	11.2	14.7	21	50	150	59.27
70-8	3D-2698	11.2	14.7	21	50	150	58.10
70-10	3D-2699	11.2	14.7	21	50	150	56.45
70-12	3D-2700	11.2	14.7	21	50	150	53.97
70-16	3D-2705	11.2	14.7	28	57	100	59.51
95-8	3D-2708	13.5	17.4	25	55	100	79.48
95-10	3D-2709	13.5	17.4	25	55	100	77.70
95-12	3D-2712	13.5	17.4	25	55	100	72.59
95-14	3D-2713	13.5	17.4	28	61	100	83.43
95-16	3D-2715	13.5	17.4	28	61	100	79.86
120-8	3D-2716	15.0	19.4	28	60	75	109.35
120-10	3D-2717	15.0	19.4	28	60	75	107.36
120-12	3D-2719	15.0	19.4	28	60	75	104.28
120-14	3D-2721	15.0	19.4	28	64	75	109.43
120-16	3D-2722	15.0	19.4	28	64	75	106.08
150-8	3D-2726	16.5	21.2	30	69	50	148.58
150-10	3D-2727	16.5	21.2	30	69	50	146.40
150-12	3D-2729	16.5	21.2	30	69	50	143.20
150-16	3D-2733	16.5	21.2	30	69	50	136.64
150-20	3D-2734	16.5	21.2	34	79	50	153.86
185-10	3D-2736	18.5	23.5	34	78	40	197.49
185-12	3D-2737	18.5	23.5	34	78	40	194.14
185-14	3D-2738	18.5	23.5	34	78	40	190.94
185-16	3D-2741	18.5	23.5	34	78	40	187.29
240-10	3D-2747	21.0	26.5	38	92	25	292.36
240-12	3D-2748	21.0	26.5	38	92	25	288.66
240-14	3D-2749	21.0	26.5	38	92	25	285.09
240-16	3D-2750	21.0	26.5	38	92	25	281.04
240-20	3D-2751	21.0	26.5	38	92	25	271.38
300-12	3D-2754	23.5	30.0	43	101	20	423.14
300-14	3D-2755	23.5	30.0	43	101	20	418.95
300-16	3D-2756	23.5	30.0	43	101	20	423.14
300-20	3D-2757	23.5	30.0	43	101	20	414.16
400-12	3D-2760	26.8	34.8	50.1	114	10	680.01
400-14	3D-2761	26.8	34.8	50.1	114	10	675.69
400-16	3D-2762	26.8	34.8	50.1	114	10	669.87
400-16	3D-2763	26.8	34.8	50.1	105	10	612.84
500-16	3D-2769	30.0	39.0	56	124	10	927.19
500-20	3D-2770	30.0	39.0	56	124	10	911.60
630-16	3D-2773	35.0	45.0	65	144	6	1409.66
630-20	3D-2774	35.0	45.0	65	144	6	1378.74

“NOTE: Certain catalogue nos. may have been discontinued from production, Please consult our sales department for an alternative.”

Tubular Cable Lugs

Extra Long Type,
W/O Inspection Hole
Material: E-copper
Surface: Tin Plated

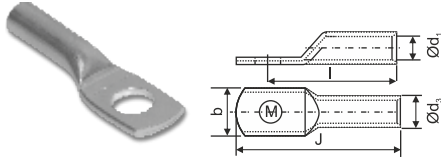

Con-Bolt mm ² -Φ	3D Cat.No.	d1	d3	b	J	Std Pkg	Price/each ₹
25-8	3D-2340	7.0	9.0	13	41	400	15.64
25-10	3D-2340A	7.0	9.0	13	41	400	14.72
35-8	3D-2341	8.0	10.6	15	48	300	27.76
35-10	3D-2341A	8.0	10.6	15	48	300	26.57
50-8	3D-2342	9.2	12.2	17	59	200	46.09
50-10	3D-2342A	9.2	12.2	17	59	200	44.70
50-12	3D-2342B	9.2	12.2	17	59	200	42.64
70-10	3D-2343	11.5	15.0	21	66	100	73.32
70-12	3D-2343A	11.5	15.0	21	66	100	70.78
95-12	3D-2344	12.8	17.0	24	74	80	109.15
95-16	3D-2344A	12.8	17.0	24	74	80	103.35
120-12	3D-2345	14.8	19.6	28	82	50	158.09
120-16	3D-2345A	14.8	19.6	28	82	50	154.93
150-12	3D-2346	16.0	21.2	30	86	40	195.68
150-16	3D-2346A	16.0	21.2	30	86	40	192.73
185-12	3D-2347	18.0	24.0	34	95	25	283.33
185-16	3D-2347A	18.0	24.0	34	95	25	281.19
185-20	3D-2347B	18.0	24.0	34	95	25	270.76
240-16	3D-2348	22.0	28.0	40	112	20	402.66
240-20	3D-2348A	22.0	28.0	40	112	20	391.93
300-16	3D-2998A	23.5	30.5	44	120	15	593.06
400-20	3D-3000A	27.5	38.5	55	140	10	1214.84

Butt Connectors

For Copper Conductors
With & Non Insulating Sleeve
Insulation : Hard PVC
Material: E-copper
Surface: Tin Plated

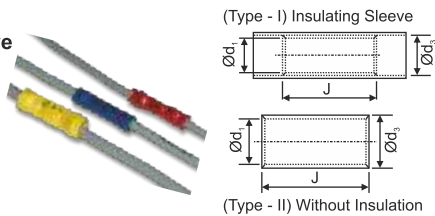

Con-Bolt mm ² -Φ	3D Cat.No.	d1	d3	J	Std Pkg	Price/each ₹
1.5-TYPE-11	3D-1845	1.6	3.2	15	5000	2.20
2.5-TYPE-11	3D-1846	2.4	4.0	15	4000	3.41
4-TYPE-11	3D-1847	3.5	5.5	15	3000	4.70
1.5-TYPE-1	3D-3762	1.6	3.2	25	1600	3.03
2.5-TYPE-1	3D-3763	2.4	4.0	25	1200	4.24
4-TYPE-1	3D-3764	3.5	5.5	27	800	5.65

Tubular Cable Lugs

Copper Light Duty W/O Inspection Hole
for Aluminum Conductors
Material: E-Copper
Surface: Tin Plate

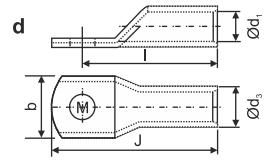

Con-Bolt mm ² -Φ	3D Cat.No.	d1	d3	b	J	Std Pkg	Price/each ₹
2.5-5	3D-2501	2.3	3.8	9	20	3000	2.38
4-6	3D-2502	3.1	4.8	11	22	2000	3.53
6-6	3D-2503	3.8	5.5	11	24	1600	4.53
10-6	3D-2504	4.5	6.2	11	24	1600	5.59
16-6	3D-2505	5.4	7.1	11	30	1000	7.83
25-6	3D-2506	7.0	9.0	13	37	400	13.96
35-6	3D-2507	8.0	10.0	15	37	400	16.03
35-8	3D-2508	8.0	10.0	15	37	400	15.26
50-6	3D-2509	9.2	11.2	16	45	250	22.48
50-8	3D-2510	9.2	11.2	16	45	250	21.67
50-10	3D-2511	9.2	11.2	16	45	250	20.45
70-8	3D-2512	11.5	13.8	20	56	150	39.23
70-10	3D-2513	11.5	13.8	20	56	150	37.45
70-12	3D-2514	11.5	13.8	20	56	150	36.70
95-10	3D-2515	12.8	15.6	23	58	100	53.27
95-12	3D-2516	12.8	15.6	23	58	100	51.49
120-10	3D-2517	14.8	17.8	26	62	75	72.04
120-12	3D-2518	14.8	17.8	26	62	75	68.60
120-16	3D-2519	14.8	17.8	26	62	75	66.63
150-10	3D-2520	16.0	19.6	28	70	50	97.21
150-12	3D-2521	16.0	19.6	28	70	50	95.02
150-16	3D-2522	16.0	19.6	28	70	50	91.22
185-12	3D-2523	18.0	22.0	32	83	40	142.78
185-16	3D-2524	18.0	22.0	32	83	40	138.53
240-16	3D-2525	22.0	26.0	38	97	25	198.36
240-20	3D-2526	22.0	26.0	38	97	25	202.14
300-16	3D-2527	24.0	28.7	42	103	20	272.73
300-20	3D-2528	24.0	28.7	42	103	20	265.46
400-20	3D-2529	28.0	33.2	49	116	15	410.19
500-20	3D-2530	30.0	36.0	53	122	10	540.80
630-20	3D-2531	35.0	41.5	61	137	10	772.30
800-BLK	3D-2532	39.0	46.3	67	165	20	
1000-BLK	3D-2533	43.0	53.8	76	210	15	

“NOTE: Certain catalogue nos. may have been discontinued from production, Please consult our sales department for an alternative.”



Precision in Every Dimension

Compression Type
Aluminum Tubular Terminal Ends for Crimping to Aluminum Conductors
 Material: Aluminum
 Surface: Natural

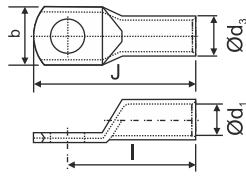

Con-Bolt mm ² -Φ	3D Cat.No.	d1	d3	b	J	Std Pkg	Price/each ₹
2.5-3	3D-2535	2.6	5.5	6.7	18	2000	1.29
4-4	3D-2536	2.9	5.5	7.2	18	2000	1.36
4-5	3D-2537	2.9	5.5	12.0	21	2000	1.33
6-6	3D-2538	3.5	5.5	12.0	23	1600	1.53
10-6	3D-2539	4.4	7.2	9.7	30	1000	2.48
10-8	3D-2540	4.4	7.2	15.0	30	800	2.29
16-6	3D-2541	5.4	8.3	11.4	37	600	3.47
16-8	3D-2542	5.4	8.3	11.7	37	600	3.86
16-10	3D-2543	5.4	8.3	18.0	38	400	3.50
25-6	3D-2544	7.0	9.7	13.7	44	400	4.49
25-8	3D-2545	7.0	9.7	13.7	44	400	4.99
25-10	3D-2546	7.0	9.7	14.0	44	400	4.42
25-12	3D-2547	7.0	9.7	20.0	44	300	4.30
35-6	3D-2548	8.0	10.8	15.4	46	300	5.35
35-8	3D-2549	8.0	10.8	15.4	46	300	5.39
35-10	3D-2550	8.0	10.8	15.7	46	300	5.40
50-8	3D-2551	9.3	13.0	18.3	54	200	9.10
50-10	3D-2552	9.3	13.0	18.3	54	200	9.12
50-12	3D-2553	9.3	13.0	18.5	54	200	9.00
70-8	3D-2554	11.3	15.5	21.8	60	100	14.14
70-10	3D-2555	11.3	15.5	21.8	60	100	13.21
70-12	3D-2556	11.3	15.5	21.8	60	100	12.55
95-10	3D-2557	13.2	17.4	24.8	64	80	17.30
95-12	3D-2558	13.2	17.4	24.8	64	80	17.30
95-16	3D-2559	13.2	17.4	24.8	64	80	15.80
120-10	3D-2560	14.7	19.6	28.0	73	50	25.75
120-12	3D-2561	14.7	19.6	28.0	73	50	24.72
120-16	3D-2562	14.7	19.6	28.0	73	50	24.72
150-10	3D-2563	16.4	21.5	30.8	79	40	31.48
150-12	3D-2564	16.4	21.5	30.8	79	40	29.65
150-16	3D-2565	16.4	21.5	30.8	79	40	29.65
185-10	3D-2566	18.4	24.0	34.5	84	40	39.58
185-12	3D-2567	18.4	24.0	34.5	84	40	40.60
185-16	3D-2568	18.4	24.0	34.5	84	40	39.60
240-12	3D-2569	21.0	28.0	40.0	102	30	68.70
240-16	3D-2570	21.0	28.0	40.0	102	30	66.80
300-16	3D-2571	23.8	31.0	45.0	115	20	88.69
300-20	3D-2572	23.8	31.0	45.0	115	20	86.80
400-20	3D-2573	26.8	35.5	50.8	130	15	134.00
500-20	3D-2574	29.5	41.0	57.8	140	10	224.60
630-20	3D-2575	34.85	46.0	65.8	154	5	216.80
800-BLK	3D-2576	39.0	51.0	73.3	180	20	342.00
1000-BLK	3D-2577	43.0	57.0	81.5	220	15	614.00

Compression Type

Aluminum Tubular In-Line Connectors for Crimping to Aluminum Conductors
 Material: Aluminum
 Surface: Natural

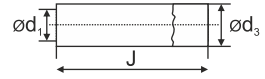

Con-Bolt mm ² -Φ	3D Cat.No.	d1	d3	J	Std Pkg	Price/each ₹
2.5	3D-2578	2.6	5.5	16	2000	1.23
4	3D-2579	2.9	5.5	16	2000	1.19
6	3D-2580	3.5	5.5	20	1600	1.51
10	3D-2581	4.4	7.2	20	1000	1.75
16	3D-2582	5.4	8.3	26	600	2.54
25	3D-2583	7.0	9.7	34	400	3.75
35	3D-2584	8.0	10.8	39	300	4.75
50	3D-2585	9.3	13.0	44	200	8.04
70	3D-2586	11.3	15.5	53	100	13.10
95	3D-2587	13.2	17.4	58	80	16.80
120	3D-2588	14.7	19.6	63	50	23.20
150	3D-2589	16.4	21.5	67	40	28.20
185	3D-2590	18.4	24.0	72	40	37.30
240	3D-2591	21.0	28.0	86	30	61.80
300	3D-2592	23.8	31.0	96	20	78.80
400	3D-2593	26.8	35.5	110	10	125.80
630	3D-2595	34.9	46.0	134	5	254.00
800	3D-2596	39.0	51.0	153	15	349.00
1000	3D-2597	43.0	57.0	201	10	539.50



ALUMINUM LUGS

ALUMINUM LUGS as per ISI specification can be supplied on Extra charges.

Tubular Cable Lugs

Extra wide palm type
 With inspection Hole
 Material - E Copper
 Surface - Tin Plated

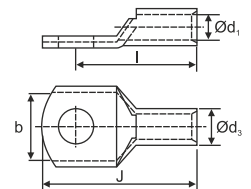

Con-Bolt mm ² -Φ	3D Cat.No.	d1	d3	b	J	Std Pkg	Price/each ₹
10-10	3D-2648	4.7	7.1	16	32	800	13.45
16-10	3D-2658	5.5	7.9	16	36	600	14.64
16-12	3D-2659	5.5	8.5	18	40	400	15.32

“NOTE: Certain catalogue nos. may have been discontinued from production, Please consult our sales department for an alternative.”



Precision in Every Dimension

Terminal Ends, Ring Type

Standard Type, W/O Sleeve,
Brazed Seam
Material: E-Copper
Surface: Tin Plated

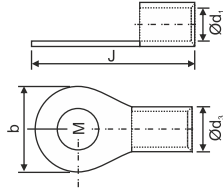

Con-Bolt mm ² -Φ	3D Cat.No.	d1	d3	b	J	Std Pkg	Price/ each ₹
0.5to1.5-3	3D-1247	1.6	3.2	6.0	14	5000	1.47
0.5to1.5-3.5	3D-1269	1.6	3.2	6.0	14	5000	1.44
0.5to1.5-4	3D-1241	1.6	3.2	6.0	14	5000	1.40
0.5to1.5-4	3D-1258	1.6	3.2	6.8	13	5000	1.39
0.5to1.5-4	3D-1246	1.6	3.2	8.0	16	5000	1.58
0.5to1.5-4	3D-1261	1.6	3.2	7.0	14.5	5000	1.45
0.5to1.5-5	3D-1262	1.6	3.2	8.0	16	5000	1.37
0.5to1.5-5	3D-1267	1.6	3.2	10.0	18	4000	1.96
0.5to1.5-6	3D-1224	1.6	3.2	10.0	18	5000	1.75
0.5to1.5-6	3D-1268	1.6	3.2	12.0	18	4000	2.18
2.5-3.5	3D-1309	2.3	3.9	8.0	16	5000	1.94
2.5-4	3D-1296	2.3	3.9	8.0	16	5000	1.75
2.5-5	3D-1304	2.3	3.9	8.0	16	5000	1.69
2.5-5	3D-1310	2.3	3.9	10.0	18	4000	2.15
2.5-6	3D-1342	2.3	3.9	10.0	18	4000	1.86
2.5-6	3D-1305	2.3	3.9	12.0	22	3000	2.76
2.5-8	3D-1307	2.3	3.9	12.0	22	3000	2.43
2.5-10	3D-1287	2.3	3.9	16.0	25	2000	3.29
2.5-10	3D-1524	2.3	3.9	18.0	29	1600	2.84
2.5-12	3D-1438	2.3	3.9	18.0	29	1000	3.76
4to6-4	3D-1432	3.5	5.5	8.0	17	3000	2.92
4to6-5	3D-1431	3.5	5.5	8.0	17	3000	2.83
4to6-5	3D-1408	3.5	5.5	10.0	19	2000	3.50
4to6-6	3D-1415	3.5	5.5	12.0	20	2000	3.70
4to6-6	3D-1417	3.5	5.5	12.0	22	2000	4.02
4to6-8	3D-1416	3.5	5.5	12.0	20	2000	3.46
4to6-8	3D-1421	3.5	5.5	14.0	25.5	1600	4.57
4to6-10	3D-1427	3.5	5.5	16.0	30	1200	5.43
4to6-12	3D-1430	3.5	5.5	18.0	30	1000	5.39
10-5	3D-1460	4.3	6.3	10.0	20	2000	4.38
10-6	3D-1465	4.3	6.3	12.0	23	1600	4.90
10-8	3D-1466	4.3	6.3	16.0	27	1200	5.92
10-10	3D-1461	4.3	6.3	18.0	30	1000	6.70
10-12	3D-1462	4.3	6.3	22.0	34	800	7.95
16-5	3D-1516	5.6	8.0	10.0	24	1000	6.54

Con-Bolt mm ² -Φ	3D Cat.No.	d1	d3	b	J	Std Pkg	Price/ each ₹
16-6	3D-1511	5.6	8.0	12.0	26	1000	7.84
16-8	3D-1512	5.6	8.0	16.0	30	800	8.90
16-10	3D-1514	5.6	8.0	18.0	33	600	9.91
16-10	3D-1520	5.6	8.0	22.0	35	400	11.98
16-12	3D-1515	5.6	8.0	22.0	35	400	11.08
25-6	3D-1561	7.5	11.1	12.0	31	400	17.13
25-6	3D-1557	7.5	11.1	16.0	30	400	18.05
25-6	3D-1558	7.5	11.1	16.0	33	400	19.30
25-8	3D-1556	7.5	11.1	12.0	31	400	16.74
25-8	3D-1552	7.5	11.1	16.0	30	400	17.89
25-8	3D-1554	7.5	11.1	16.0	33	400	18.68
25-10	3D-1553	7.5	11.1	16.0	30	400	16.78
25-10	3D-1559	7.5	11.1	18.0	34	400	19.25
25-10	3D-1560	7.5	11.1	22.0	42	300	24.83
25-12	3D-1555	7.5	11.1	22.0	42	300	23.58
35-6	3D-1584	9.0	12.6	16.0	31	400	21.07
35-8	3D-1581	9.0	12.6	16.0	31	400	19.90
35-8	3D-1585	9.0	12.6	18.0	36	400	23.54
35-10	3D-1582	9.0	12.6	18.0	36	300	22.64
35-10	3D-1586	9.0	12.6	22.0	42	300	27.47
35-12	3D-1583	9.0	12.6	22.0	42	300	25.46
50-8	3D-1609	10.5	14.1	18.0	43	200	32.37
50-10	3D-1607	10.5	14.1	18.0	43	200	31.59
50-10	3D-1610	10.5	14.1	22.0	43	200	32.84
50-12	3D-1608	10.5	14.1	24.0	48	200	35.34
70-10	3D-1637	12.0	16.0	22.0	47	150	44.47
70-12	3D-1636	12.0	16.0	22.0	47	150	43.35
95-10	3D-1651	13.5	18.1	22.0	46	100	57.30
95-10	3D-1652	13.5	18.1	24.0	50	100	58.28
95-12	3D-1650	13.5	18.1	24.0	50	100	60.32
120-12	3D-1658	15.0	20.2	26.0	52	100	81.44

“NOTE: Certain catalogue nos. may have been discontinued from production, Please consult our sales department for an alternative.”



Precision in Every Dimension

Tubular Cable Lugs

Compression Type, Aluminium Terminal ends, for Crimping to XLPE Conductors
Material : Aluminium
Surface : Natural

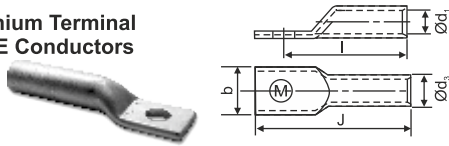

Con-Bolt mm ² -Φ	3D Cat.No.	d1	d3	b	J	Std Pkg	Price/each ₹
16-6	3D-4000	5.0	8.3	12.0	66	400	8.24
25-8	3D-4001	7.2	9.6	14.0	66	200	7.85
35-8	3D-4002	8.3	11.1	16.0	76	150	10.63
50-10	3D-4003	10.1	13.5	19.5	78	100	14.74
70-10	3D-4004	11.2	14.5	20.5	93	80	22.42
95-12	3D-4005	12.0	16.9	23.5	107	50	34.03
120-12	3D-4006	13.7	19.0	26.5	111	40	42.40
150-12	3D-4007	15.1	21.1	29.5	125	25	58.21
150-16	3D-4008	15.1	21.1	29.5	125	25	57.42
185-12	3D-4009	16.6	23.9	33.0	128	20	79.29
185-16	3D-4010	16.6	23.9	33.0	128	20	78.17
240-12	3D-4012	19.3	27.2	37.5	141	15	107.33
240-16	3D-4013	19.3	27.2	37.5	141	15	106.10
300-20	3D-4014	21.8	30.2	42.0	154	10	134.86
300-12	3D-4015	21.8	30.2	42.0	154	15	137.32
300-16	3D-4016	21.8	30.2	42.0	154	15	136.34
400-20	3D-4017	25.0	34.8	48.0	184	40	212.97
500-20	3D-4018	28.2	39.1	54.0	202	25	291.11
630-BLK	3D-4019	31.7	44.4	61.0	222	20	424.25
800-BLK	3D-4020	35.7	49.5	68.0	247	15	596.84
1000-BLK	3D-4021	41.0	56.0	77.5	277	10	818.72

Terminal Ends, Fork Type

Standard Type, Brazed Seam
Material: E-Copper
With PVC Sleeve
Surface: Tin Plated

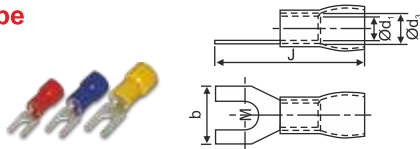

Con-Bolt mm ² -Φ	3D Cat.No.	d1	d3	b	J	Std Pkg	Price/each ₹
0.5to1.5-3	3D-3640	1.6	3.2	6.0	19	2000	1.84
0.5to1.5-3.5	3D-3641	1.6	3.2	6.0	19	2000	1.81
0.5to1.5-3.5	3D-3639	1.6	3.2	6.8	19	2000	1.65
0.5to1.5-4	3D-3647	1.6	3.2	6.5	20	2000	1.85
0.5to1.5-5	3D-3650	1.6	3.2	8.0	21	2000	2.02
2.5-3	3D-3671	2.4	4.0	5.6	19	2000	2.04
2.5-3.5	3D-3657	2.3	3.9	6.5	20	2000	1.92
2.5-4	3D-3663	2.3	3.9	8.0	21	1600	2.38
2.5-5	3D-3664	2.3	3.9	10.0	24	1600	2.87
4to6-3.5	3D-3675	3.5	5.5	6.0	24	1000	3.35
4to6-4	3D-3679	3.6	5.6	8.0	27	1000	4.01
4to6-4	3D-3720	3.5	5.5	8.0	25	1000	3.56
4to6-5	3D-3721	3.5	5.5	8.0	25	1000	3.46
0.5to1.5-3.5	3D-3685	1.6	3.2	6.8	19	2000	2.24
2.5-3.5	3D-3687	2.3	3.9	6.5	20	2000	2.60
4to6-3.5	3D-3690	3.5	5.5	6.0	24	1000	4.22

Terminal Ends, Fork Type

Standard Type, Brazed Seam
Material: E-Copper
Surface: Tin Plated

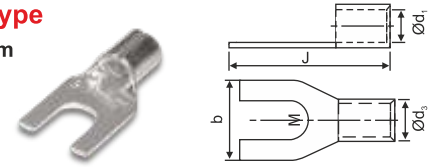

Con-Bolt mm ² -Φ	3D Cat.No.	d1	d3	b	J	Std Pkg	Price/each ₹
0.5to1.5-3	3D-1923	1.6	3.2	6.0	14	5000	1.53
0.5to1.5-3.5	3D-1699	1.6	3.2	6.8	14.5	5000	1.29
0.5to1.5-3.5	3D-1700	1.6	3.2	6.0	14	5000	1.51
0.5to1.5-4	3D-1704	1.6	3.2	6.5	15	5000	1.58
0.5to1.5-5	3D-1875	1.6	3.2	8.0	16	5000	1.71
2.5-3	3D-1902	2.4	4.0	5.6	14	5000	1.71
2.5-3.5	3D-1884	2.3	3.9	6.5	15	5000	1.54
2.5-4	3D-1891	2.3	3.9	8.0	16	5000	2.02
2.5-5	3D-1892	2.3	3.9	10.0	19	3000	2.49
2.5-5	3D-1903	2.6	4.6	10.6	21	2000	3.56
4to6-3.5	3D-1907	3.5	5.5	6.0	15	3000	2.63
4to6-4	3D-1733	3.5	5.5	8.0	17	2000	3.12
4to6-4	3D-1914	3.6	5.6	8.0	18	2000	3.39
4to6-5	3D-1734	3.5	5.5	8.0	17	2000	3.04
16-5	3D-1922	5.3	7.7	10.0	26	1000	7.28

Connectors, Non-Tention Type

Standard Type with Cable Stopper
Material: E-copper
Surface: Tin Plated

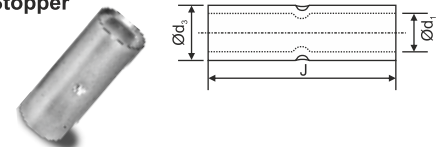

Con-Bolt mm ² -Φ	3D Cat.No.	d1	d3	J	Std Pkg	Price/each ₹
1.5	3D-2802	1.8	3.7	12	2000	2.10
2.5	3D-2804	2.4	4.0	15	2000	2.50
4	3D-2806	3.1	4.8	15	2000	3.00
6	3D-2808	3.8	5.5	15	2000	3.44
10	3D-2810	4.5	6.2	20	1600	5.09
16	3D-2812	5.4	7.1	20	1200	5.93
25	3D-2817	6.8	8.8	32	400	13.28
35	3D-2820	8.2	10.6	36	300	21.27
50	3D-2823	10.0	12.8	40	200	32.92
70	3D-2826	11.2	14.7	40	100	46.88
95	3D-2828	13.5	17.4	45	100	69.92
120	3D-2830	15.0	19.4	45	80	87.72
150	3D-2833	16.5	21.2	55	50	125.34
185	3D-2836	18.5	23.5	65	40	175.11
240	3D-2838	21.0	26.5	80	25	267.18
300	3D-2841	23.5	30.0	85	20	377.43
400	3D-2843	26.8	34.8	91	10	572.98

"NOTE: Certain catalogue nos. may have been discontinued from production, Please consult our sales department for an alternative."

Terminal Ends, Ring Type

Standard Type, With Insulating Sleeve
Material: E-Copper With PVC Sleeve
Surface: Tin Plated

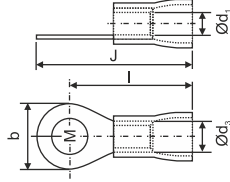

Con-Bolt mm ² -Φ	3D Cat.No.	d1	d3	b	J	Std Pkg	Price/ each ₹
0.5 to 1.5-3	3D-3078	1.6	3.2	6	19	2000	1.79
0.5 to 1.5-3.5	3D-3079	1.6	3.2	6	19	2000	1.76
0.5 to 1.5-4	3D-3080	1.6	3.2	6	19	2000	1.72
0.5 to 1.5-4	3D-3083	1.6	3.2	6.8	18	2000	1.71
0.5 to 1.5-4	3D-3085	1.6	3.2	8	21	2000	2.04
0.5 to 1.5-4	3D-3087	1.6	3.2	7	19.5	2000	1.78
0.5 to 1.5-5	3D-3086	1.6	3.2	8	21	2000	1.95
0.5 to 1.5-5	3D-3074	1.6	3.2	10	23	2000	2.33
0.5 to 1.5-6	3D-3089	1.6	3.2	10	23	2000	2.16
0.5 to 1.5-6	3D-3090	1.6	3.2	12	23	2000	2.58
2.5-3.5	3D-3128	2.3	3.9	8	21	2000	2.34
2.5-4	3D-3129	2.3	3.9	8	21	2000	2.30
2.5-5	3D-3130	2.3	3.9	8	21	2000	2.22
2.5-5	3D-3131	2.3	3.9	10	23	1600	2.63
2.5-6	3D-3132	2.3	3.9	10	23	2000	2.49
2.5-6	3D-3134	2.3	3.9	12	27	1200	3.22
2.5-8	3D-3135	2.3	3.9	12	27	1200	2.96
2.5-10	3D-3138	2.3	3.9	16	30	1000	3.81
2.5-10	3D-3139	2.3	3.9	18	34	1000	3.32
2.5-12	3D-3140	2.3	3.9	18	34	1000	4.34
4 to 6-4	3D-3196	3.5	5.5	8	25	1000	3.79
4 to 6-5	3D-3197	3.5	5.5	8	25	1000	3.67
4to6-5	3D-3199	3.5	5.5	10	27	1000	4.18
4to6-5	3D-3204	3.5	5.5	12	30	800	5.01
4to6-6	3D-3202	3.5	5.5	12	28	800	4.47
4to6-6	3D-3205	3.5	5.5	12	30	800	4.78
4to6-8	3D-3203	3.5	5.5	12	28	800	4.16
4to6-8	3D-3207	3.5	5.5	14	33.5	800	5.39
4to6-10	3D-3210	3.5	5.5	16	38	600	6.32
4to6-12	3D-3213	3.5	5.5	18	38	600	6.28

Terminal Ends, Ring Type

Double Grip With Insulating Sleeve
Material: E-Copper + PVC
Surface: Tin Plated

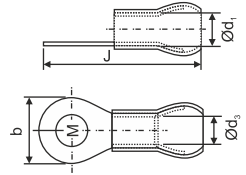

Con-Bolt mm ² -Φ	3D Cat.No.	d1	d3	b	J	Std Pkg	Price/ each ₹
0.5to1.5-3	3D-3338	1.6	3.2	6.0	19	2000	2.40
0.5to1.5-3.5	3D-3339	1.6	3.2	6.0	19	2000	2.36
0.5to1.5-4	3D-3340	1.6	3.2	6.0	19	2000	2.32
0.5to1.5-4	3D-3343	1.6	3.2	6.8	18	2000	2.31
0.5to1.5-4	3D-3345	1.6	3.2	8.0	21	2000	2.66
0.5to1.5-5	3D-3346	1.6	3.2	8.0	21	2000	2.58
0.5to1.5-6	3D-3350	1.6	3.2	10.0	23	2000	2.79
0.5to1.5-6	3D-3351	1.6	3.2	12.0	23	2000	3.22
2.5-4	3D-3385	2.3	3.9	8.0	21	2000	3.06
2.5-5	3D-3386	2.3	3.9	8.0	21	2000	2.96
2.5-5	3D-3387	2.3	3.9	10.0	23	2000	3.41
2.5-6	3D-3388	2.3	3.9	10.0	23	2000	3.25
2.5-6	3D-3390	2.3	3.9	12.0	27	1600	4.03
2.5-8	3D-3391	2.3	3.9	12.0	27	1600	3.75
2.5-10	3D-3394	2.3	3.9	16.0	30	1000	4.64
4to6-4	3D-3493	3.5	5.5	8.0	26	1000	4.70
4to6-5	3D-3494	3.5	5.5	8.0	26	1000	4.54
4to6-5	3D-3496	3.5	5.5	10.0	28	1000	5.05
4to6-6	3D-3499	3.5	5.5	12.0	29	800	5.34
4to6-6	3D-3502	3.5	5.5	12.0	31	800	5.64
4to6-8	3D-3504	3.5	5.5	14.0	34.5	800	6.26

Terminal Ends, Rectangular Pin Type

Brazed Seam,
Material : E Copper
Surface : Tin Plated

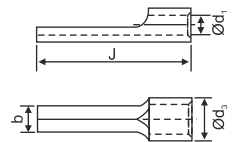

Con-Bolt mm ² -Φ	3D Cat.No.	d1	d3	b	J	Std Pkg	Price/ each ₹
10	3D-1041	4.3	6.7	4.3	22	1600	5.77
16	3D-1043	5.8	8.2	5.5	26	1000	8.69
25	3D-1044	7.5	11.1	7	31	400	19.82
35	3D-1045	9	12.6	8	37	400	26.20
50	3D-1046	10.5	14.1	9	42	200	34.49
70	3D-1047	12	16	10	45	100	47.77

Terminal Ends, Round Pin Type

W/O Sleeve, Brazed Seam
Material: E-Copper
Surface: Tin Plated

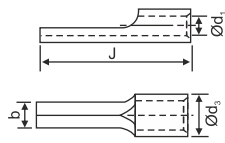

Con-Bolt mm ² -Φ	3D Cat.No.	d1	d3	b	J	Std Pkg	Price/each ₹
0.5 TO 1.5	3D-1012	1.6	3.2	1.9	17	5000	1.39
2.5	3D-1021	2.3	3.9	1.9	17	5000	1.58
4	3D-1030	2.9	4.9	2.7	20	3000	3.03
6	3D-1036	3.6	5.6	2.7	20	3000	3.41

Terminal Ends, Round Pin Type

Double Grip, With Insulating Sleeve
Material: E-Copper With PVC Sleeve
Surface: Tin Plated

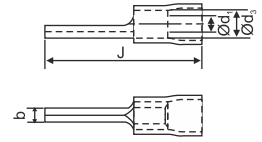

Con-Bolt mm ² -Φ	3D Cat.No.	d1	d3	b	J	Std Pkg	Price/each ₹
0.5to1.5	3D-3040	1.6	3.2	1.9	22	2000	2.28
2.5	3D-3043	2.3	3.9	1.9	22	2000	2.65
4	3D-3046	2.9	4.9	2.7	29	1000	5.02

Terminal Ends, Insulated Flat Pin Type Double Grip

With Insulating Sleeve
Material: E-Copper With PVC Sleeve
Surface: Tin Plated

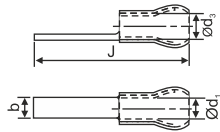

Con-Bolt mm ² -Φ	3D Cat.No.	d1	d3	b	J	Std Pkg	Price/each ₹
2.5	3D-3044	2.3	3.9	3.1	22	2000	2.65

Terminal Ends, Flat Pin Type

Standard Type w/o Sleeve, Brazed Seam
Material: E-Copper
Surface: Tin Plated

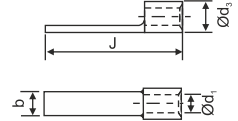

Con-Bolt mm ² -Φ	3D Cat.No.	d1	d3	b	J	Std Pkg	Price/each ₹
0.5to1.5	3D-1011	1.6	3.2	3.1	17	5000	1.51
2.5	3D-1022	2.3	3.9	3.1	17	5000	1.73
4to6	3D-1032	3.6	5.6	5.1	20	2000	3.39

Terminal Ends, Round Pin Type

With Insulating Sleeve
Material: E-Copper With PVC Sleeve
Surface: Tin Plated

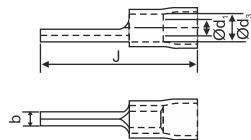

Con-Bolt mm ² -Φ	3D Cat.No.	d1	d3	b	J	Std Pkg	Price/each ₹
0.5to1.5	3D-3008	1.6	3.2	1.9	22	2000	1.67
2.5	3D-3022	2.3	3.9	1.9	22	2000	1.91
4	3D-3026	2.9	4.9	2.7	28	1000	3.90

Terminal Ends, Insulated Flat Pin Type

With Insulating Sleeve
Material: E-Copper With PVC Sleeve
Surface: Tin Plated

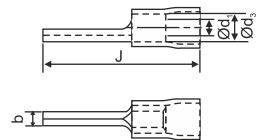

Con-Bolt mm ² -Φ	3D Cat.No.	d1	d3	b	J	Std Pkg	Price/each ₹
0.5to1.5	3D-3009	1.6	3.2	3.1	22	2000	1.85
2.5	3D-3023	2.3	3.9	3.1	22	2000	2.04
4to6	3D-3027	3.6	5.6	5.1	28	1000	3.92

“NOTE: Certain catalogue nos. may have been discontinued from production, Please consult our sales department for an alternative.”

Bi-Metallic Lugs

Bi-Metallic Lugs and Connectors are made from the Highest Quality Electrolytic Grade Copper & Aluminium which are joined using a friction welding process.

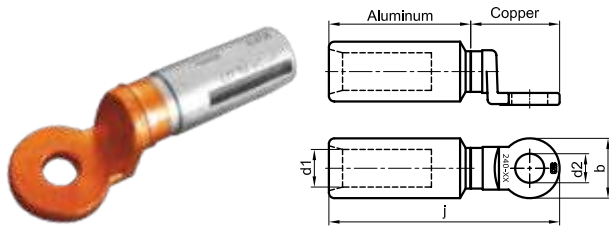

3D Cat.No.	j	Ø d1	b
3D BL 6-XX	75	3.5	20
3D BL 10-XX	75	4.5	20
3D BL 16-XX	75	5.5	20
3D BL 25-XX	75	7.5	20
3D BL 35-XX	75	8.5	20
3D BL 50-XX	75	9.5	24
3D BL 70-XX	75	11.5	24
3D BL 95-XX	115	13.5	24
3D BL 120-XX	115	15.5	30
3D BL 150-XX	120	16.5	30
3D BL 185-XX	120	18.5	3
3D BL 240-XX	135	22	3
3D BL 300-XX	135	23.5	36
3D BL 400-XX-B	145	26	36
3D BL 400RT-XX	160	26.5	50
3D BL 500RT-XX	160	30	50
3D BL 500-XX*	160	30	50
3D BL 630-XX*	175	34	60

*Rectangle Palm

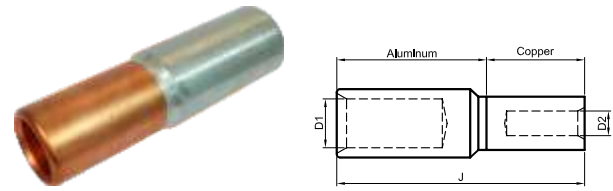

Conductor MM²	3DCAT NO.	Dimensions in mm		
		ØD1	ØD2	J
35-35	3DBF 35-35	8.5	8.5	70
50-35	3DBF 50-35	9.5	8.5	70
50-50	3DBF 50-50	9.5	9.5	70
70-50	3DBF 70-50	11.5	9.5	70
70-70	3DBF 70-70	11.5	11.5	70
95-70	3DBF 95-70	13.5	11.5	110
95-95	3DBF 95-95	13.5	13.5	110
120-95	3DBF 120-95	15.5	13.5	110
120-120	3DBF 120-120	15.5	15.5	110
150-120	3DBF 150-120	16.5	15.5	120
150-150	3DBF 150-150	16.5	16.5	120
185-150	3DBF 185-150	18.5	16.5	120
185-185	3DBF 185-185	18.5	18.5	120
240-185	3DBF 240-185	22	18.5	120
240-240	3DBF 240-240	22	21.5	120
300-240	3DBF 300-240	23.5	21.5	120
300-300	3DBF 300-300	23.5	23.5	120
400-300	3DBF 400-300	26.5	23.5	155
400-400	3DBF 400-400	26.5	26.5	155

Copper Split Bolt Connectors (Cold Formed)

Features

- **UL listed** for copper stranded wires only.
- Manufactured from high **strength**, high **conductivity** copper.
- Precision tooled **Cold Formed** threads.

Application

- Suitable for **direct burial** application in earth and concrete.
- Splicing, tapping or terminating conductors in power and grounding electrical connection.



Standards

- Tested and Listed to **UL 486A, UL486B** requirements.
- **CSA C22.2 No.65** Listed
- **UL 467** Listed for **Grounding and Bonding**, this does not apply to 3D SB-1000.
- **ROHS** compliance.

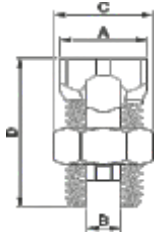

CATALOG NUMBER	WIRE RANGE			Recommended Torque In-lbs (N-m)	Dimensions (inch)			
	RANGE OF EQUAL MAIN AND TAP		MIN TAP WITH ONE MAX MAIN		A	B	C	D
	MIN	MAX						
3D SB-8	16 STR/SOL	8 STR/SOL	16 SOL/STR	80 (9)	0.38	0.15	0.50	0.85
3D SB-6	10 SOL/STR	6 SOL/STR	16 SOL/STR	165 (18.6)	0.50	0.17	0.63	1.05
3D SB-4	8 SOL/STR	4 STR	16 SOL/STR	165 (18.6)	0.56	0.22	0.69	1.05
3D SB-2	6 SOL/STR	2 STR	14 SOL/STR	275 (31.1)	0.69	0.33	0.82	1.32
3D SB-3	4 STR	2 STR	8 SOL/STR	275 (31.1)	0.60	0.26	0.75	1.50
3D SB-1/0	4 STR	1/0 STR	14 SOL/STR	385 (43.5)	0.73	0.38	0.94	1.77
3D SB-2/0	2 STR	2/0 STR	14 SOL/STR	385 (43.5)	0.82	0.44	1.05	1.94
3D SB-3/0	2 STR	3/0 STR	8 SOL/STR	500 (56.5)	0.82	0.48	1.05	1.94
3D SB-250	1/0 STR	250 kcmil	8 SOL/STR	650 (73.4)	1.00	0.60	1.39	2.25
3D SB-350	4/0 STR	350 kcmil	1/0 STR	650 (73.4)	1.41	0.71	1.70	2.60
3D SB-500	250 kcmil	500 kcmil	2/0 STR	825 (93.2)	1.48	0.85	1.82	2.83
3D SB-750	350 kcmil	750 kcmil	4/0 STR	1000 (113)	1.94	1.02	2.31	3.51
3D SB-1000	500kcmil	1000 kcmil	4/0 STR	1100 (124.3)	2.19	1.17	2.56	3.90

“NOTE: Certain catalogue nos. may have been discontinued from production, Please consult our sales department for an alternative.”

COPPER STRIPS/BUS BARS



We offer high quality copper strips and bus bars. Copper Strips and plates are used in distinct industries because of their various unique characteristics, including electrical and thermal conductivity. They also have superior mechanical properties, malleability and formability. These copper strips and plates can be easily fabricated, welded or soldered. Our range of copper strip can be produced in different width and thickness as per the demand of the customers. Continuous strip-casting machines are used to produce long, weld-free coils of uniform composition and properties. On the other hand, our automatic electronic gauge-controls help maintain consistent thickness.

SIZE RANGE - BUSBARS	SIZE RANGE - COPPER STRIP
Width: 25mm-225mm	Width : 5mm to 100mm.
Thickness: 2mm-50mm	Thickness : 0.5mm to 10mm.

COPPER RODS



Copper rods are finished by cold drawing after casting. They are available in a comprehensive range of sizes with superb dimensional accuracy & finish.

Our copper rods are used for connectors, electrical motor components, electroplating, switchgear, ship building and power generating equipment.

COPPER RODS (ROUNDS)
Outer Ø from 8mm to 25mm. Available in straight lengths/coils

COPPER TUBES & PIPES.



We produce a wide range of seamless tubes in various shapes such as round, rectangular, square, hexagonal etc.

They are supplied in straight lengths. These tubes are used in general engineering, terminal-lug manufacturing and other electrical applications.

COPPER TUBE (ROUNDS)	COPPER TUBE (RECTANGULAR PROFILE)
Outer Ø 3mm to 52mm. Wall thickness 0.8 to 7mm depending on outer Ø of tubes.	Outer size 6mm to 50mm. W Wall thick thickness 1mm to 7mm.

Dealer / Distributor



Precision in every dimension

billets ELEKTRO WERKE PVT. LTD.

1014 & 1015, 10th Floor, Panchshil Plaza, Gamdevi,
Hughes Road, Grant Road (West), Mumbai-400 007
+91-22-23694201 / 23694202
sales@bewl.in, export@bewl.in
www.bewl.in



- All Prices are Ex-works, Umbergaon, GUJARAT.
- Prices are subject to change w/o any notice.
- Please confirm the price and availability of the materials before placing the order.
- Product's Dimensions and standard packing quantity can be changed without prior notice.